

Compatibility configuration for Windows 10 :

1. Modify the Software properties :

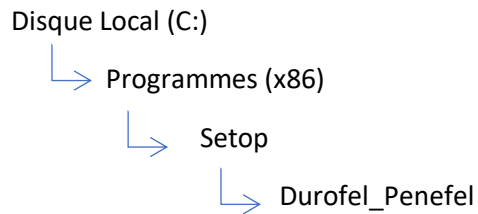

Right click on DUROPENFEL.exe, then click on Properties

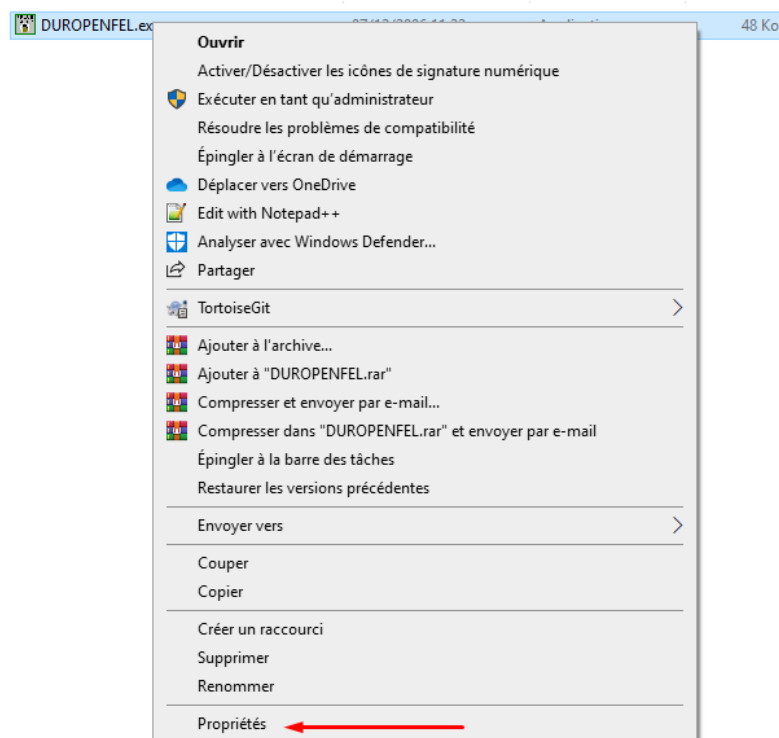
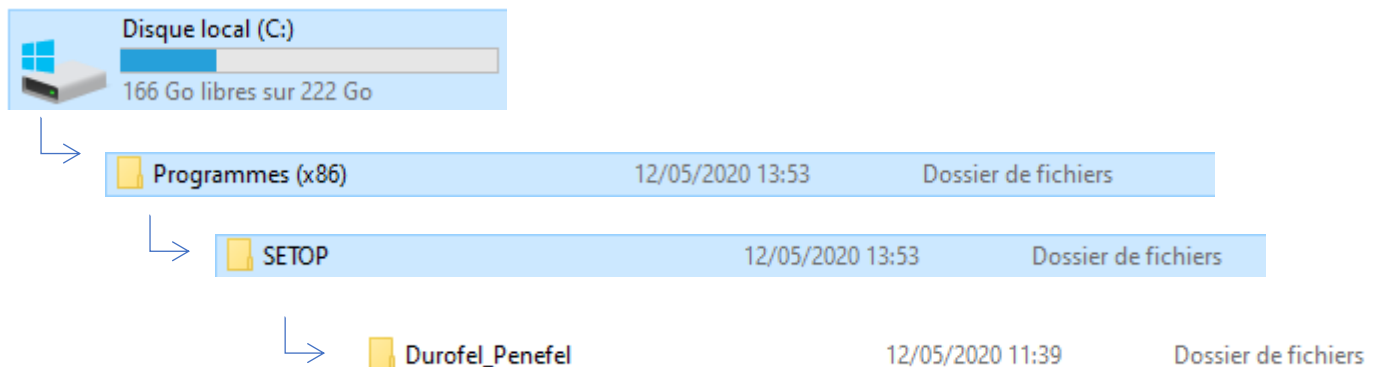

2. Modify the compatibility

Click on the tab « Compatibility », then on « Change settings for all users »

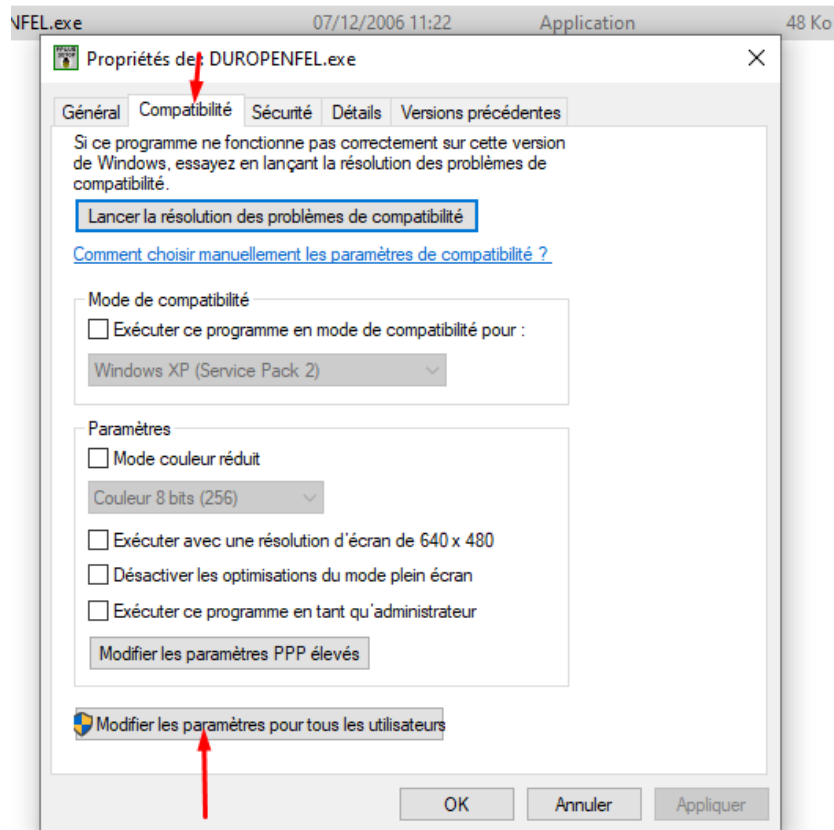

Then in the window that opened, check « Run this program in compatibility mode for » **(1)**, then select « Windows XP (Service Pack 3) » **(2)**.

Then check « Run this program as an administrator » **(3)**.

Apply **(4)**, then Ok.

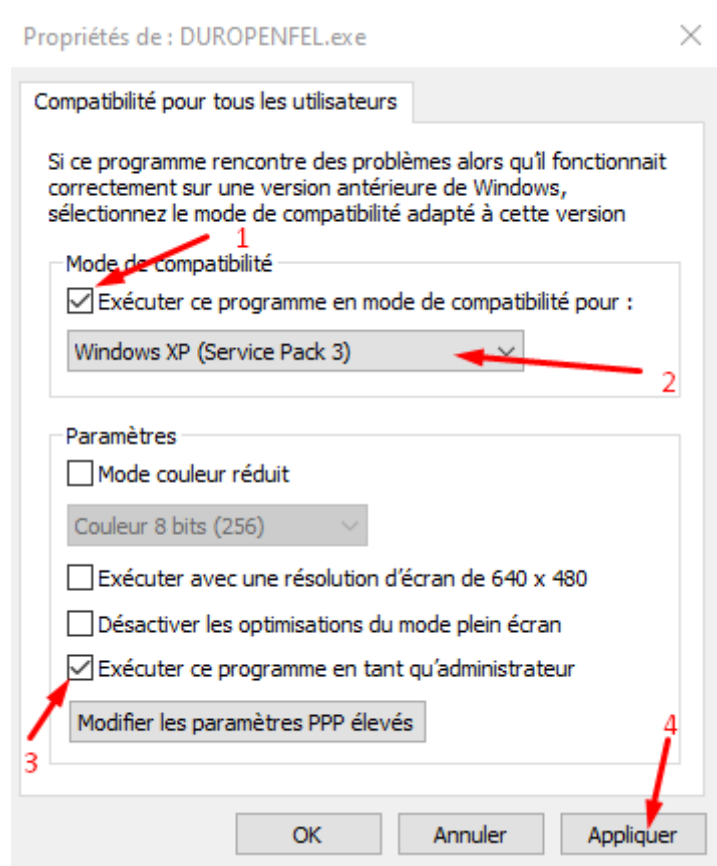

3. Modify permissions

In properties, go in the tab « Security », then click on « Edit ».

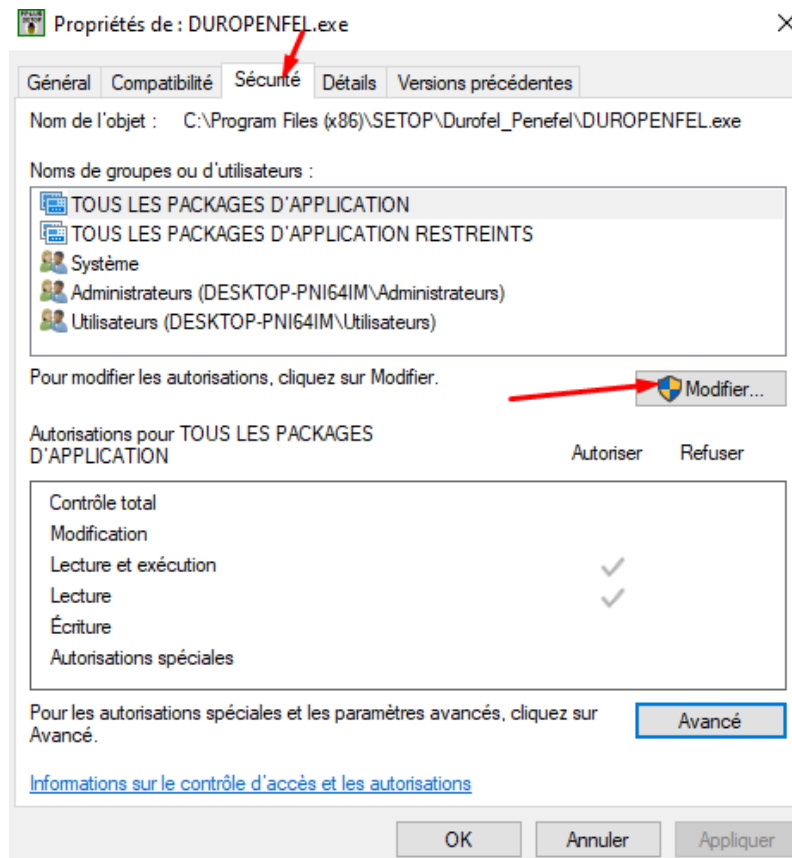

Then in the window that opened, click on « TOUS LES PACKAGES D'APPLICATION », then check « Full Control ».

Do the same for « TOUS LES PACKAGES D'APPLICATION RESTREINTS » and for « Utilisateurs »

Finish by clicking « Apply », then « Ok »

